

TOPDEK

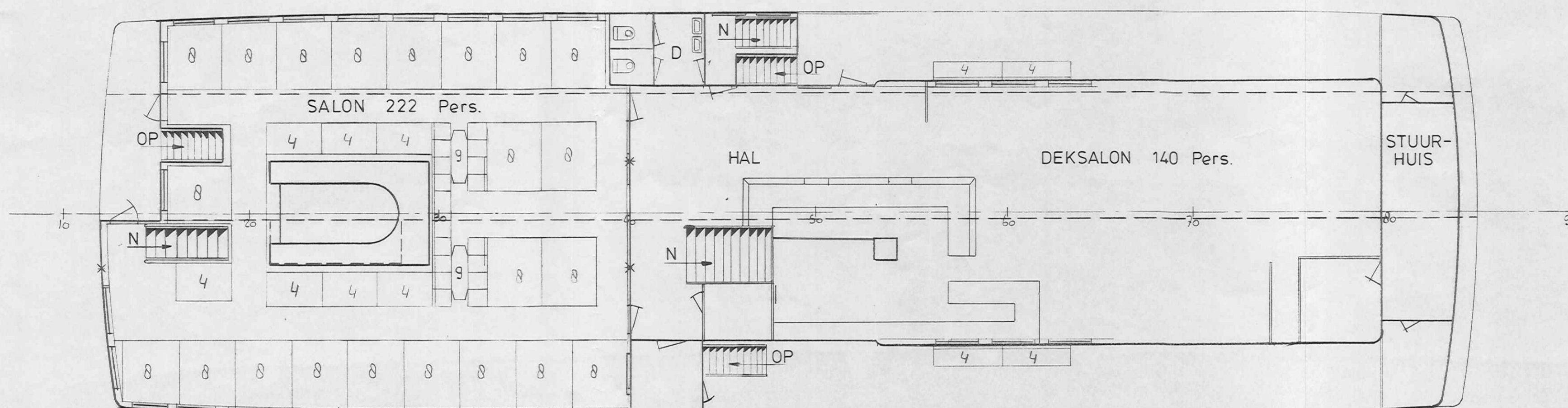

PROMENADEDEK

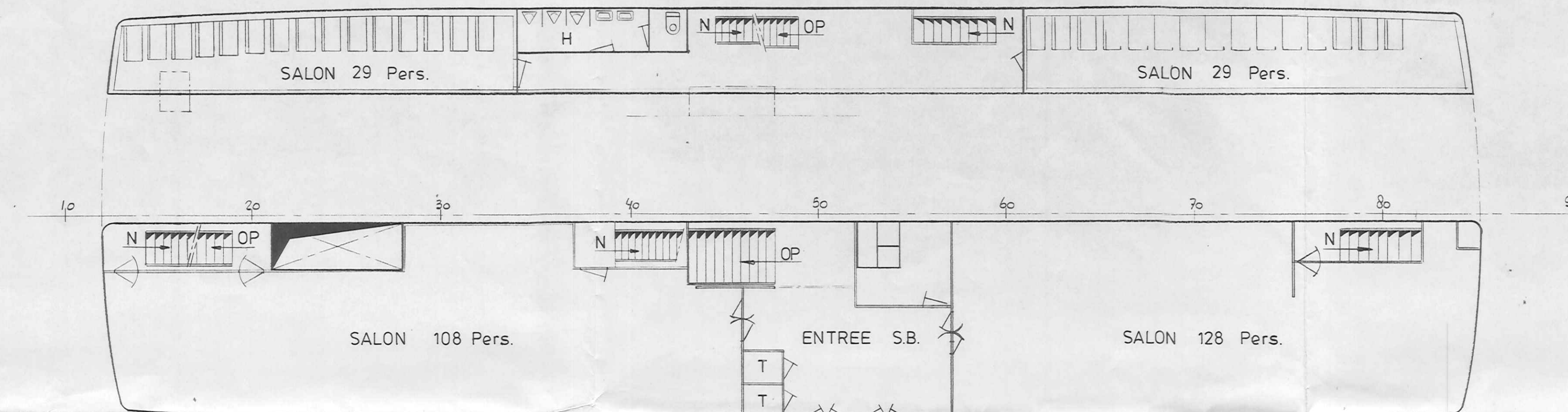

SALONDEK

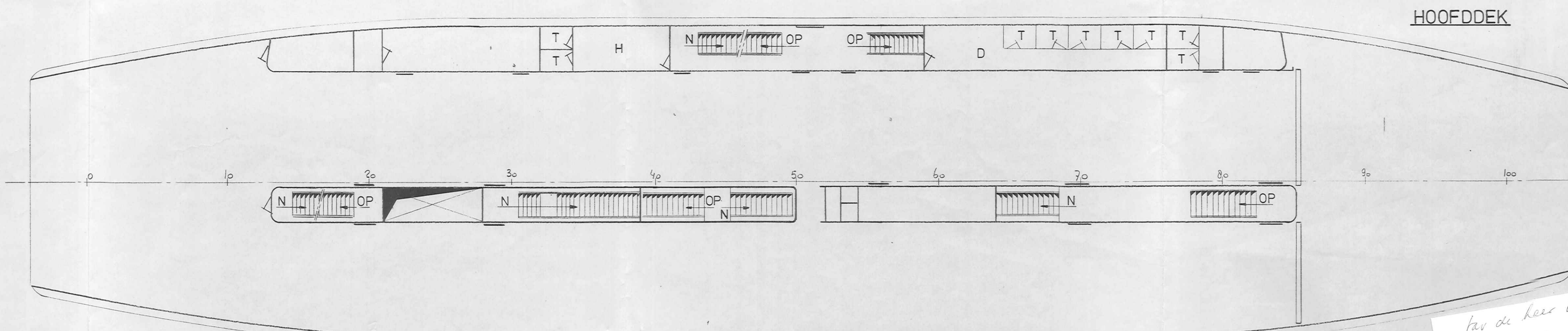

HOOFDDEK

HOOFDAFMETINGEN :

| | |
|--------------------|---------|
| Lengte o.a. | 59,66 M |
| Lengte l.l. | 56,89 M |
| Breedte o.a. | 12,49 M |
| Breedte op Spant | 12,00 M |
| Holte tot Hoofddek | 4,00 M |
| Diepgang | 2,22 M |
| Spantafstand | 0,55 M |
| Snelheid | 15 KN |
| Aantal passagiers | 1000 |

(2x1150 PK)

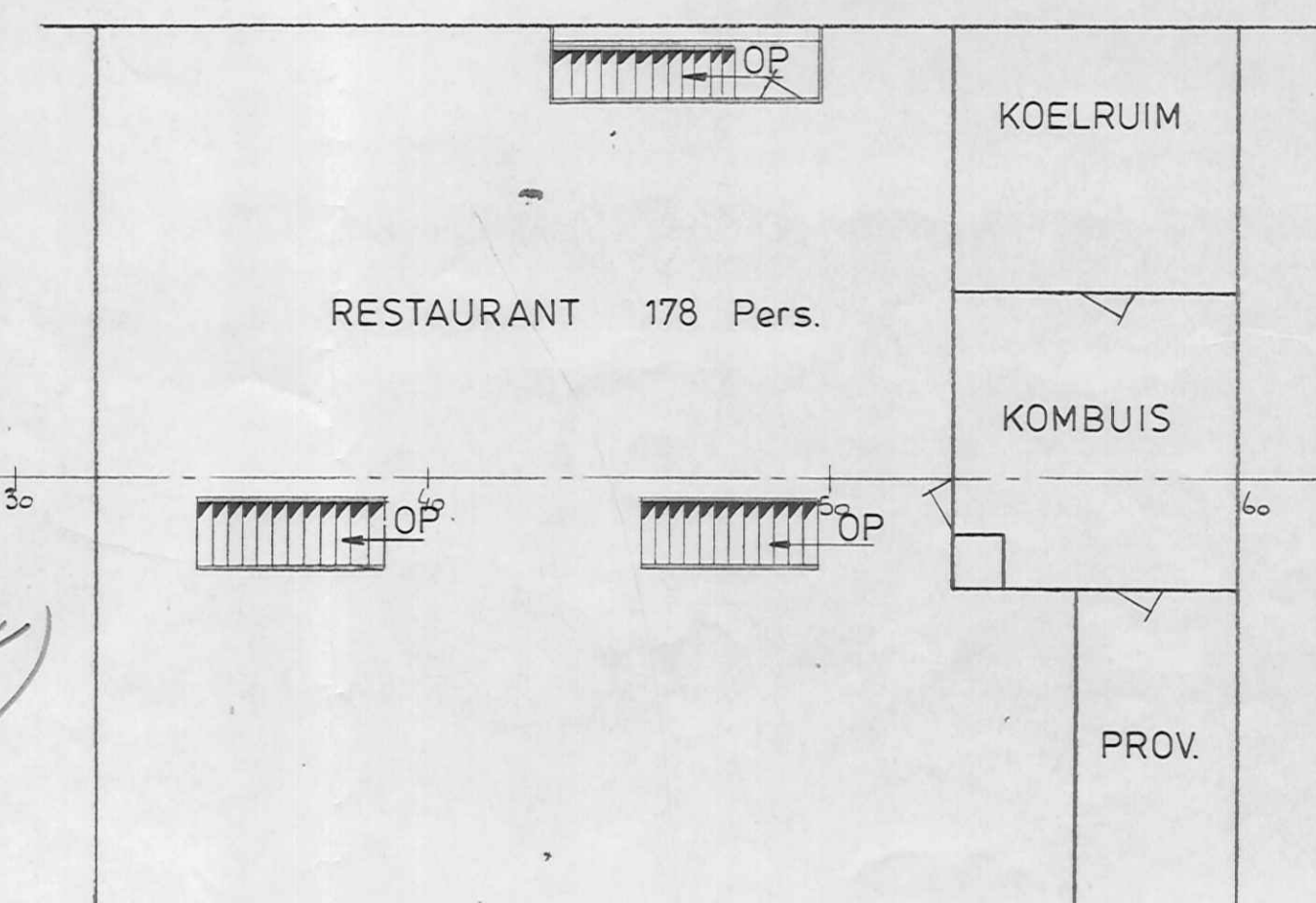

TANKDEK

van de heer Veenma
u
toegezonden
door: G.T. Chelhaar

29 APR. 1988

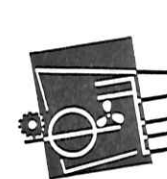

scheepswerf
welgelegen
nieuwbouw- en reparatiebedrijf b.v.
postbus 1 - 6860 aa harlingen
tel. 05178-2744

| | | | |
|-----------------------------------|-------------------------|-------------------------------|-----------------------------|
| GOEDGEKEURD DOOR: APPROVED BY: | DATUM: DATE: | PROJECT: PROJECT: | BENAMING: NAME: |
| | | m.s. Vlieland | ALGEMEEN PLAN |
| GET. / S. Torenbeek | 25-2-88 | ORDER NR. ORDER NO. | PROJECTIE: PROJECT: |
| GEK. / CHECKED: | | | OPMERKINGEN REMARKS |
| VERV. DOOR: REPLACED BY: | VERVANGT: REPLACING: | BEHOORT BIJ: BELONGING TO: | SCHAAL: SCALE: |
| | | | 1:100 |
| | | | TEKENING NR. DRAWING NO. |
| | | | 5258 |